

# Homesite 2 S Tyee Lane

Oregon City, OR 97045

## Priced At

\$1,335,000

The Reserve at Riverstone

The Alpine Floor Plan

- 3691  
Square Feet
- 4  
Bedrooms
- 3.5  
Bathrooms
- 4  
Car Garage





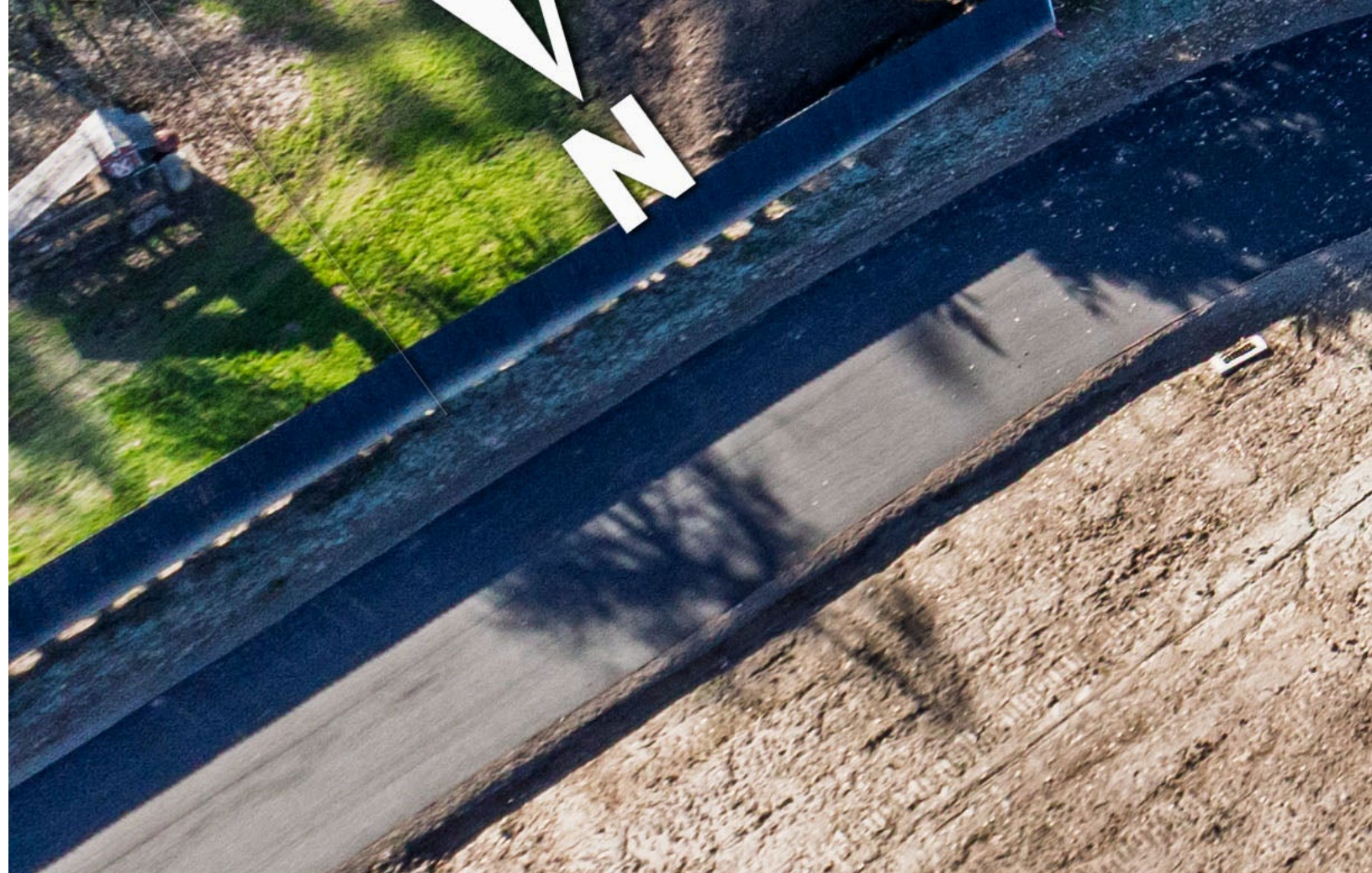

This 6.06-acre homesite at The Reserve at Riverstone in Oregon City, OR offers an exceptional opportunity to build your dream home in a private, nature-filled setting. Surrounded by beautiful Pacific Northwest greenery, the property provides ample space, privacy, and flexibility for a wide range of home designs and outdoor features. Conveniently located just minutes from shopping, dining, groceries, and everyday amenities, this homesite delivers the ideal balance of peaceful acreage living and modern convenience. The property is currently paired with the Alpine home plan to showcase its potential, while still offering the flexibility to choose from a variety of thoughtfully designed home plans to fit your lifestyle.

Come home to the Alpine, an estate-sized home that comes equipped with all the space you need to live life exactly the way you envision. With 3,650 square feet of living space and from four to seven bedrooms, this home design has the flexibility to grow with you, providing your family with a timeless home full of modern conveniences.

The Alpine features a traditional two-story floor plan that offers an exceptional living experience, high-performance features, and modern comforts. Rich in detail and character, stacked stone and siding exteriors make an impressive first impression, with four appealing architectural styles to choose from, including Craftsman, farmhouse, and modern.

Feel right at home as you enter through a charming covered front porch with transom windows.

The downstairs includes many features that allow you to live in complete comfort and harmony. A dedicated entry welcomes you to this classic and elegant design, and a den off the hallway offers an inviting space to relax or a private home office or study room. Larger families may select an optional bedroom with full bath instead. The end of the hall opens to a spacious, two-story great room, and its volume ceilings create an expansive space with lots of natural light. An inviting open-concept layout distinguishes each room, while clear sight lines encourage gathering and connection throughout the kitchen, great room, and dining room.

The gourmet kitchen with a luxe center island and walk-in pantry will appeal to home chefs and avid entertainers alike. Don't be surprised if family and friends look to you as the host for future gatherings and celebrations, as the Alpine's contemporary layout is designed to accommodate everyday and special occasions. Large sliding glass doors from the kitchen lead to a covered patio for easy outdoor living, and an optional fireplace will keep you cozy and comfortable all year long. A bonus room off the great room can serve any number of purposes, or opt for a guest room with an ensuite full bath as a private retreat for out-of-town guests. Convenient garage entry opens to a mud room with optional built-in shelving and a drop zone for stowing shoes, bags, and backpacks to reduce clutter in the main living areas. From the mud room, enjoy convenient access to a four-car garage with plenty of space for multiple vehicles, storage, and even a small workshop.

On the second floor, step immediately into an open loft that's perfect for an additional private lounge space, with the area beyond open to below or as an optional bonus room. A convenient upstairs laundry room with optional built-ins makes chore day a breeze. Travel down a short hallway to the primary suite, where you can relax and unwind in the included retreat area with an optional fireplace. Enjoy all the comforts of a well-appointed primary bath and dressing area, including a large soaking tub, dual sinks, optional mud-set shower, and his-and-hers walk-in closets. Three sizable secondary bedrooms are also located upstairs for privacy and comfort, one of which includes its own full bath ideal for an older child or guests.

The Alpine is designed with families in mind, with versatile spaces to accommodate many different lifestyles. Even so, as with every Garrette home, the floor plan also offers incredible flexibility and a number of structural options so you can bring your dream home to life.

Some of the many available options:

- Bedroom with Full Bath at Den
- Double Oven in the Kitchen
- Fireplace in the Covered Patio
- Fireplace in the Great Room
- Guest Suite with Full Bath at First-Floor Bonus Room
- Drop Zone at Mud Room
- Additional Two-Car Garage
- Bonus Room on Second Floor

- Fireplace in Primary Bedroom
- Custom Mud-Set Shower in primary Bath

Rich in architectural detail, the Alpine is an exceptional home that offers families the flexibility to live beautifully on their own terms.  
None