



GARRETTE HOMES

TO BE BUILT

SITE	HOME PLAN	SQ FT	BED/BATH	GARAGES	ADDRESS	BASE PRICE
6 ph. 2	The Shasta	2,958	3 / 2.5	3-car	17004 NE 281st St.	\$1,130,000



GARRETTE HOMES



MOUNTAIN VALLEY ESTATES

GARRETTE HOMES

OREGON CCB #173524; WA LIC #PACIFLH924R1, #GARRECH875LC Plan is preliminary, square footage is approximate, illustration is for representational purposes only, and availability is subject to change without notice. GCH Puget Sound Inc. is a licensed real estate brokerage in Washington State. REV 10/21/25



● To Be Built / Design Studio Ready ● Sold



GARRETTE HOMES

TO BE BUILT

SITE	HOME PLAN	SQ FT	BED/BATH	GARAGES	ADDRESS	BASE PRICE
5	The Jefferson	2,500	3 / 2.5	4-car RV	6285 NW McMaster Dr	\$1,367,000
4	The Rainier	3,213	4 / 2.5	3-car	6243 NW McMaster Dr	\$1,374,000
3	The Aspen	3,122	3 / 3.5	3-car	6201 NW McMaster Dr	\$1,380,000
1	The Alpine	3,691	4 / 3.5	4-car tandem	6151 NW McMaster Dr	\$1,386,000



GARRETTE HOMES



THE ENCLAVE AT CAMAS MEADOWS

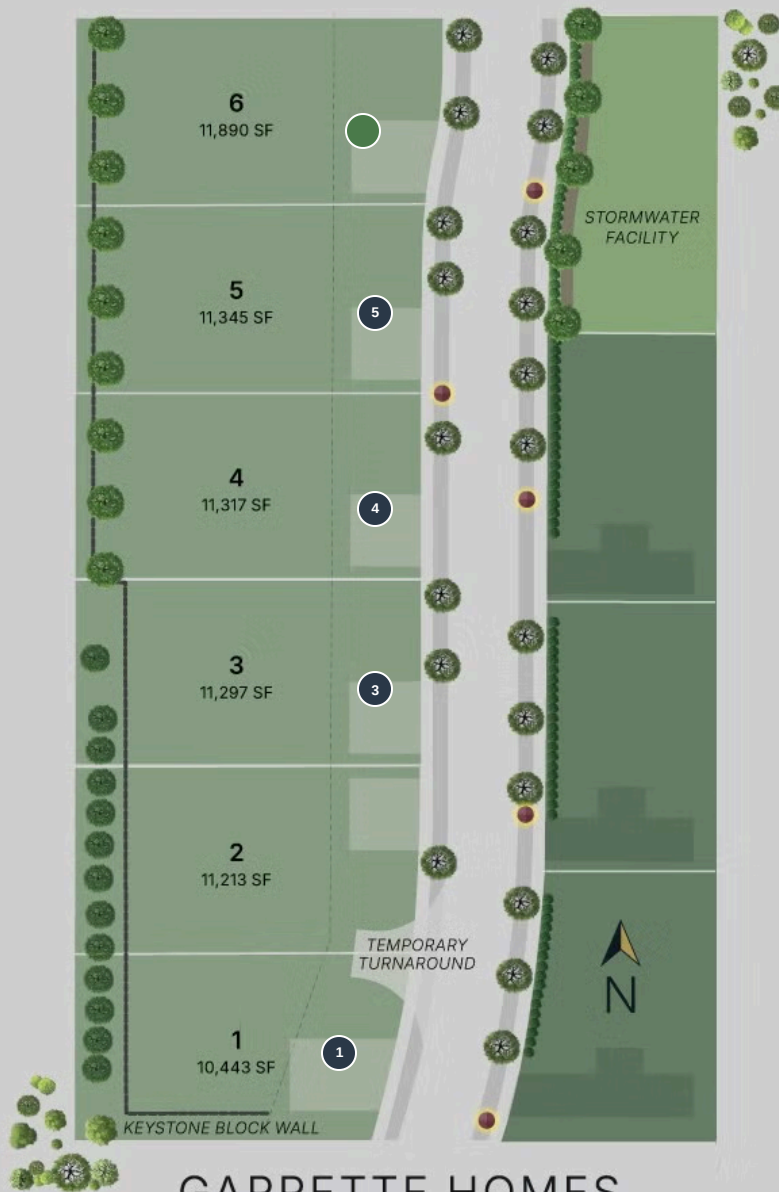

GARRETTE HOMES

● To Be Built / Design Studio Ready ● Model Home

TO BE BUILT

SITE	HOME PLAN	SQ FT	BED/BATH	GARAGES	ADDRESS	BASE PRICE
21	The Molalla	2,005	2 / 2	2-car	2064 S River Rd	\$749,000
19	The Sage	2,353	4 / 2.5	2-car	2056 S River Rd	\$767,000
22	The Rogue	2,527	3 / 2.5	3-car	2068 S River Rd	\$799,000

QUICK MOVE-IN

SITE	HOME PLAN	SQ FT	BED/BATH	GARAGES	ADDRESS	TOTAL PRICE
40	The Deschutes	1,912	3 / 2	2-car	2142 S River Rd	\$699,000



THE
RETREAT
AT RIVERS EDGE

GARRETTE HOMES

OREGON CCB # 173524; WA LIC # PACIFLH924R1 & #GARRECH875LC
Plan is preliminary, square footage is approximate, illustration is for
representational purposes only, and availability is subject to change without
notice. GCH Puget Sound Inc. is a licensed real estate brokerage in
Washington State. REV 10/14/25



● Quick Move-In
 ● To Be Built / Design Studio Ready
 ● Sold